

PHIPPEN LOT

The Phippen Lot is in the Town of Angelica. The Lot is landlocked. It is located between the Common Road and the East Road. The access to the property is a right-of-way off the Common Road through private property. There are 39 acres in the Lot.

The Lot was once part of a farm. Upon acquiring the Lot, the County planted the open land to conifers. Multiflora rose and honeysuckle shrubs are in the understory to varying degrees. If left unchecked, they will continue to spread and become a serious problem when it is time to regenerate the stand. Heavy multiflora rose and honeysuckle shade out the seedlings of the desirable timber species.

STAND #1: Hardwoods – Sawtimber, Poles and Saplings – 9 acres

	Major Species	Minor Species
Large Sawtimber	red oak	bitternut hickory basswood white ash
Small Sawtimber	red oak red maple	sugar maple red maple basswood
Poles	red oak white ash	sugar maple shagbark hickory bitternut hickory Yellow birch ironwood
Saplings	white ash red oak bitternut hickory	

Stand #1 was once a stand of large red oak. Around 30 years ago, the large oaks were harvested for timber. The cutting was heavy enough, so there is still not crown closure in the overstory. This has allowed enough sunlight to reach the understory to reproduce the stand. At that time, there were some smaller oaks that weren't cut for timber. These trees are now large sawtimber trees. There are now small sawtimber trees, poles, and saplings in the stand. These smaller diameter classes still have a red oak component, but the smaller the diameter class, the smaller the percentage of red oak.

The stand has cull trees and needs a light thinning in places. This can be done commercially by a fuelwood sale or pre-commercially. The culls could also be taken out in the next timber harvest. There is some honeysuckle and multiflora rose just getting started in the stand. It should be eradicated before it gets any worse.

There are not enough large sawtimber oaks for a sale by themselves. They could, however, be added to the next hardwood timber sale on the C. Horner Lot. If not, the County should wait until enough smaller trees reach their economic maturity to get enough volume for a sale.

STAND#2: Hardwoods – Poles and Small Sawtimber – 1 acre

	Major Species	Minor Species
Small Sawtimber	red oak	red maple basswood white pine
Poles	red maple white ash	shagbark hickory sugar maple beech sweet birch
Saplings	blue beech ironwood	

Stand #2 is a poor stand of hardwood poles and scattered small sawtimber. This stand was also cut around 30 years ago. There is not as much red oak as there is in Stand #1. The stand is wet and poorly drained. There is heavy blue beech and ironwood that came in the understory after the last timber harvest. No work is needed in the stand.

STAND #3: Red Pine and Norway Spruce – Poles and Small Sawtimber – 9 acres

	Major Species	Minor Species
Poles & Small Sawtimber	red pine Norway spruce	
Seedling – Sapling	sugar maple black cherry red maple white ash ironwood	

Stand #3 is abandoned agricultural land planted to red pine and Norway spruce. The trees are now pole and small sawtimber size. The red pine is planted off site at close spacing. The crowns are small. There has been thinning in the stand, but it was too late. The red pine has not responded to the thinning. The reproduction varies from good to poor. There is honeysuckle and multiflora rose getting started in the stand. It should be eradicated.

The red pine has reached its full potential and should be harvested. There is not enough of the spruce to make a sale by itself in the future, so it should be harvested along with the red pine. The stand should be converted to hardwoods through natural hardwood succession.

STAND #4: Hardwoods – Poles – 2 acres

	Major Species	Minor Species
Poles	white ash	red maple red oak aspen

Stand #4 is a wet poorly drained area that was once planted to red pine. Almost all the red pine died. The stand has seeded into almost all white ash poles. There is moderate honeysuckle in the understory. It should be eradicated to keep it from spreading to other stands.

STAND #5: White Pine and Hardwoods – Poles and Seedling – Sapling – 10 acres

	Major Species	Minor Species
Poles	white pine	white ash red maple sugar maple
Seedling – Sapling	white ash red oak black cherry sugar maple beech bitternut hickory	

Stand #5 is abandoned agricultural land planted to white pine at close spacing (4 feet x 4 feet). The pine has good form, but very small crowns due to the close spacing. There has been some windthrow in the wetter parts of the stand. There are some hardwood saplings and poles that have seeded in the stand. The hardwood reproduction is good in places. There is honeysuckle and multiflora rose just starting to come in the stand. It should be eradicated before it becomes a problem. The pine has reached its full potential. It should be harvested and the stand converted to hardwoods.

STAND #6: Hardwoods – Small Sawtimber and Poles – 4 acres

	Major Species	Minor Species
Large Sawtimber	red oak white ash	
Small Sawtimber	white ash red maple	
Poles	white ash	red maple sugar maple red oak white pine

Stand #6 is abandoned agricultural land planted to white pine. The stand is downwind from a good hardwood seed source. The white pine was taken over by faster growing hardwoods that seeded in the stand. There are a few scattered white pines in the understory.

Large sawtimber trees are in the stand, but they are few and scattered. Some are along the western boundary line. Most of the trees are pole and small sawtimber size. They are mostly white ash. There is honeysuckle starting in the stand. It should be eradicated while it is still easy to do so. The large sawtimber trees and sawtimber white ash can be harvested when Stand #1 has a timber sale.

STAND #7: Hardwoods – Poles, Saplings and Small Sawtimber – 4 acres

	Major Species	Minor Species
Poles	red maple white ash	red oak
Saplings	red maple white ash	beech blue beech
Small Sawtimber	red oak aspen red maple	

Stand #7 is a hardwood stand whose trees are predominately pole size. There are also saplings and a few scattered small sawtimber trees. The Stand is overstocked and need thinning. The good red oaks should be favored. Thin the stand pre-commercially because of the small average diameter of the trees.

RECOMMENDATIONS:

1. Harvest all conifers in a conifer sale in Stands #3 and 5.
2. Harvest the large sawtimber and white ash small sawtimber in Stand #1 and 6. There is not enough timber volume in the lot for a sale on this lot alone. These stands should be combined with the next timber sale on the C. Horner Lot.
3. Do cull removal and a light thinning in Stand #1 through a fuelwood sale.
4. Thin Stand #7 pre-commercially.
5. Eradicate invasive species in Stands #1, 3, 4, 5 and 6.
6. Maintain the boundary lines.

PHIPPEN LOT

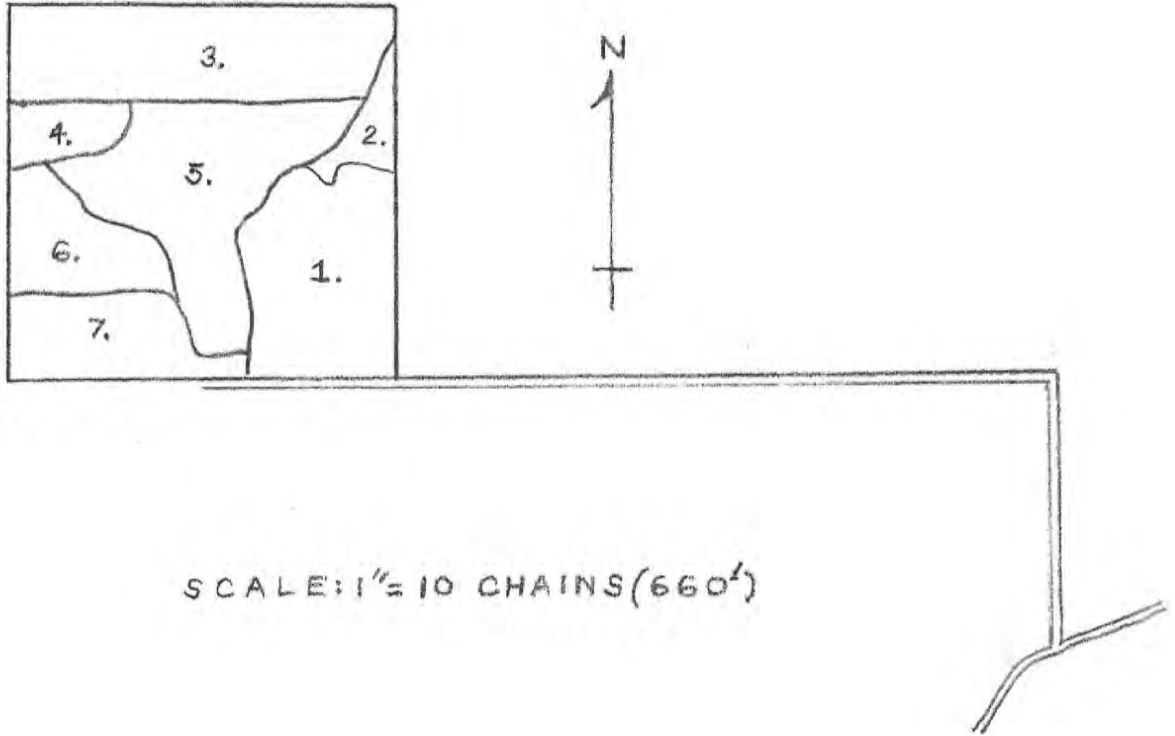



Allegheny County Forest
Phippen Lot
Town of Angelica
Map Updated: 2/7/2012

1 inch equals 1,000 feet

